



Witcomb Lodge Lancaster Gardens , East Finchley, N2 9AJ

A beautifully presented two bedroom apartment situated in this modern block in Lancaster Gardens, N2. The property has been maintained to a very high level and has been recently decorated throughout. Other features include a spacious reception and dining area, a fully fitted modern kitchen, and a sleek family bathroom. Both bedrooms are generously sized, with ample internal storage throughout whilst also offering a private balcony and secure underground parking.

£375,000

Witcomb Lodge Lankaster Gardens

, East Finchley, N2 9AJ



- Two Well Proportioned Bedrooms
- Bright Spacious Reception Dining Room
- Modern Fitted Kitchen
- Modern Bathroom
- Private Balcony
- Communal Gardens
- Secure Allocated Underground Parking
- Beautifully Presented



[Directions](#)



Floor Plan

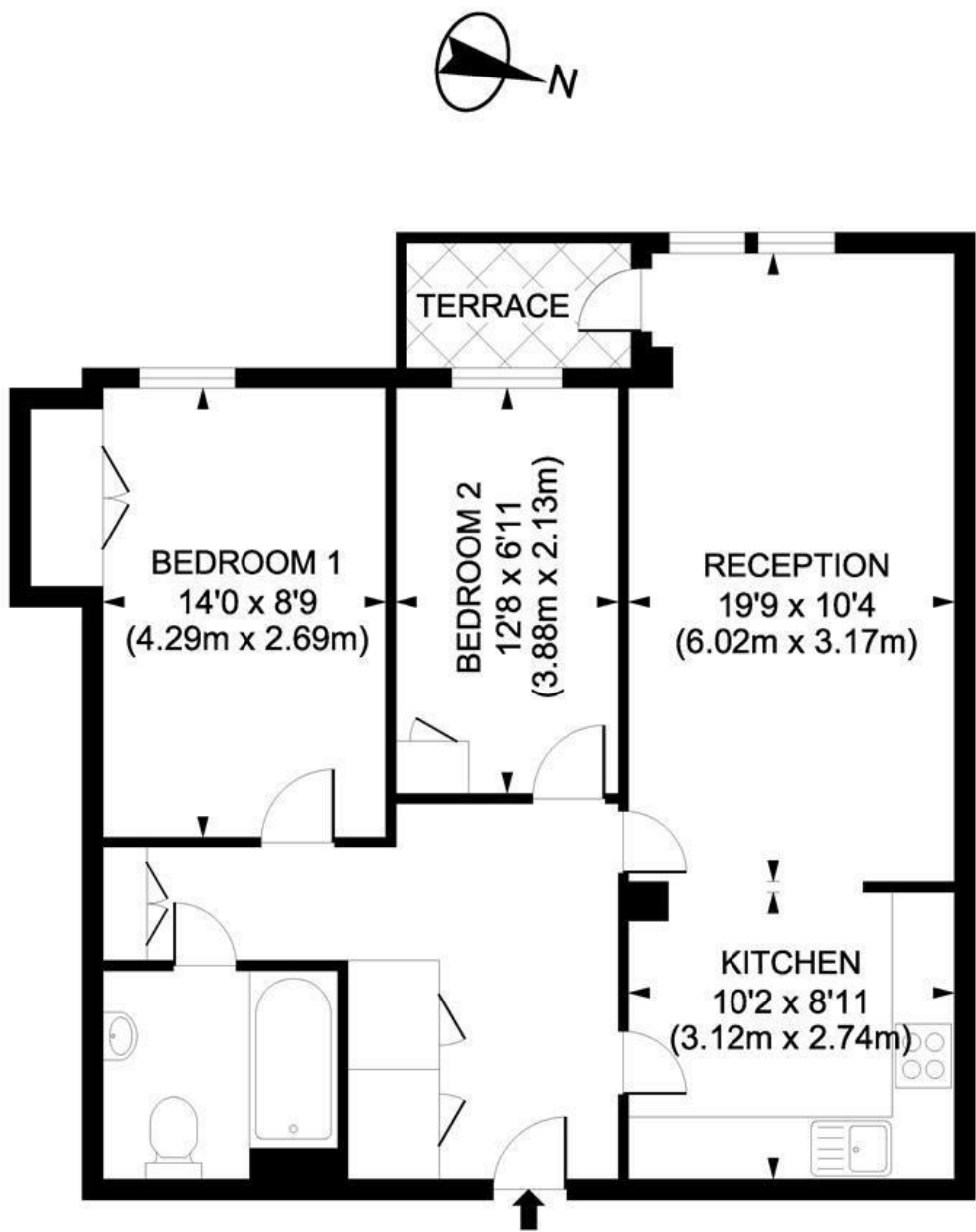

SECOND FLOOR

Whitcomb Lodge, London, N2

Gross Internal Area 721 sq ft/67 sq metres

Whilst every attempt has been made to ensure the accuracy of the floorplan shown, all measurements, positioning fixtures, fittings and any other data shown are an approximate interpretation for illustrative purposes only and are not to scale. No responsibility is taken for any error, omission, miss-statement or use of data shown.

These particulars, whilst believed to be accurate are set out as a general outline only for guidance and do not constitute any part of an offer or contract. Intending purchasers should not rely on them as statements of representation of fact, but must satisfy themselves by inspection or otherwise as to their accuracy. No person in this firms employment has the authority to make or give any representation or warranty in respect of the property.

Energy Efficiency Rating		
	Current	Potential
Very energy efficient - lower running costs		
(92 plus) A		
(81-91) B		
(69-80) C		
(55-68) D		
(39-54) E		
(21-38) F		
(1-20) G		
Not energy efficient - higher running costs		
England & Wales		
EU Directive 2002/91/EC		